



## 30V N-Channel Trench Power MOSFET

### General Description

The SJM30N060 uses advanced trench technology to provide excellent  $R_{DS(ON)}$ , low gate charge and operation with gate voltages as low as 4.5V. This device is suitable for use as a wide variety of applications.

### Features

- Low Gate Charge
- High Power and current handling capability
- Lead free product is acquired

### Application

- PWM Applications
- Load Switch
- Power Management

### Key Performance Parametes

Parameter	Value	Unit
$V_{DS}$	30	V
$R_{DS(ON\_TYP)}$	6	m $\Omega$
$I_D$	50	A
$Q_G$	21.6	nC

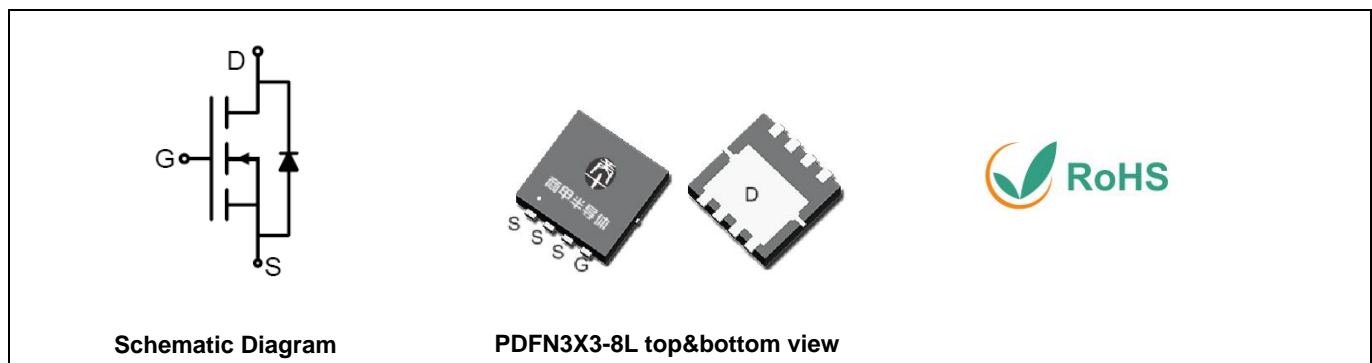

### Package Marking and Ordering Information

Device/Ordering Code	Marking	Package	Packing	Reel Size	Tape width	Quantity
SJM30N060	SJM30N060	PDFN3X3-8L	Tape	\	\	5000 Pcs

**Table 1. Absolute Maximum Ratings ( $T_A=25^{\circ}\text{C}$  unless otherwise noted)**

Symbol	Parameter	Limit	Unit
$V_{DS}$	Drain-Source Voltage ( $V_{GS}=0\text{V}$ )	30	V
$V_{GS}$	Gate-Source Voltage ( $V_{DS}=0\text{V}$ )	$\pm 20$	V
$I_D$	Drain Current-Continuous( $T_C=25^{\circ}\text{C}$ )	50	A
	Drain Current-Continuous( $T_C=100^{\circ}\text{C}$ )	32	A
$I_{DM}$ (pluse)	Drain Current-Continuous@ Current-Pulsed (Note 1)	200	A
$P_D$	Maximum Power Dissipation( $T_C=25^{\circ}\text{C}$ )	30	W
	Maximum Power Dissipation( $T_C=100^{\circ}\text{C}$ )	12	W
$E_{AS}$	Avalanche energy (Note 2)	72	mJ
$T_J, T_{STG}$	Operating Junction and Storage Temperature Range	-55 To 150	$^{\circ}\text{C}$

**Table 2. Thermal Characteristic**

Symbol	Parameter	Typ	Max	Unit
$R_{\theta JC}$	Thermal Resistance, Junction-to-Case		4.2	$^{\circ}\text{C/W}$



## 30V N-Channel Trench Power MOSFET

**Table 3. Electrical Characteristics ( $T_J=25^{\circ}\text{C}$  unless otherwise noted)**

Symbol	Parameter	Conditions	Min	Typ	Max	Unit
On/Off States						
BV <sub>DSS</sub>	Drain-Source Breakdown Voltage	V <sub>GS</sub> =0V I <sub>D</sub> =250μA	30			V
I <sub>DSS</sub>	Zero Gate Voltage Drain Current	V <sub>DS</sub> =30V, V <sub>GS</sub> =0V T <sub>J</sub> =25℃			1	μA
		V <sub>DS</sub> =30V, V <sub>GS</sub> =0V T <sub>J</sub> =125℃			100	μA
I <sub>GSS</sub>	Gate-Body Leakage Current	V <sub>GS</sub> =±20V, V <sub>DS</sub> =0V			±100	nA
V <sub>GS(th)</sub>	Gate Threshold Voltage	V <sub>DS</sub> =V <sub>GS</sub> , I <sub>D</sub> =250μA	1		2.5	V
g <sub>FS</sub>	Forward Transconductance	V <sub>DS</sub> =5V, I <sub>D</sub> =20A		25		S
R <sub>DS(ON)</sub>	Drain-Source On-State Resistance	V <sub>GS</sub> =10V, I <sub>D</sub> =20A T <sub>J</sub> =25℃		6	7.5	mΩ
R <sub>DS(ON)</sub>	Drain-Source On-State Resistance	V <sub>GS</sub> =4.5V, I <sub>D</sub> =10A T <sub>J</sub> =25℃		9.2	12.2	mΩ
Dynamic Characteristics						
C <sub>iss</sub>	Input Capacitance	V <sub>DS</sub> =15V, V <sub>GS</sub> =0V, f=1.0MHz		1062		pF
C <sub>oss</sub>	Output Capacitance			130		pF
C <sub>rss</sub>	Reverse Transfer Capacitance			114		pF
R <sub>g</sub>	Gate resistance	V <sub>GS</sub> =0V, V <sub>DS</sub> =0V, f=1.0MHz		1.53		Ω
Switching Parameters						
t <sub>d(on)</sub>	Turn-on Delay Time	V <sub>GS</sub> =10V, V <sub>DS</sub> =15V, R <sub>L</sub> =0.75Ω, R <sub>GEN</sub> =3Ω		6.4		nS
t <sub>r</sub>	Turn-on Rise Time			346		nS
t <sub>d(off)</sub>	Turn-Off Delay Time			19.4		nS
t <sub>f</sub>	Turn-Off Fall Time			9.8		nS
Q <sub>g</sub>	Total Gate Charge	V <sub>GS</sub> =10V, V <sub>DS</sub> =15V, I <sub>D</sub> =20A		21.2		nC
Q <sub>gs</sub>	Gate-Source Charge			2.32		nC
Q <sub>gd</sub>	Gate-Drain Charge			4.24		nC
Source-Drain Diode Characteristics						
I <sub>SD</sub>	Source-Drain Current (Body Diode)				50	A
V <sub>SD</sub>	Forward on Voltage (Note 3)	V <sub>GS</sub> =0V, I <sub>S</sub> =20A			1.2	V
t <sub>rr</sub>	Reverse Recovery Time	I <sub>F</sub> =20A, dI/dt=500A/μs		20		ns
Q <sub>rr</sub>	Reverse Recovery Charge	I <sub>F</sub> =20A, dI/dt=500A/μs		11		nC

Notes 1.Repetitive Rating: Pulse width limited by maximum junction temperature.

Notes 2.EAS condition:  $T_J=25^{\circ}\text{C}, V_{DD}=30V, V_G=10V, R_g=25\Omega, L=0.5\text{mH}$ .

Notes 3.Repetitive Rating: Pulse width limited by maximum junction temperature.



## 30V N-Channel Trench Power MOSFET

### Typical Electrical And Thermal Characteristics (Curves)

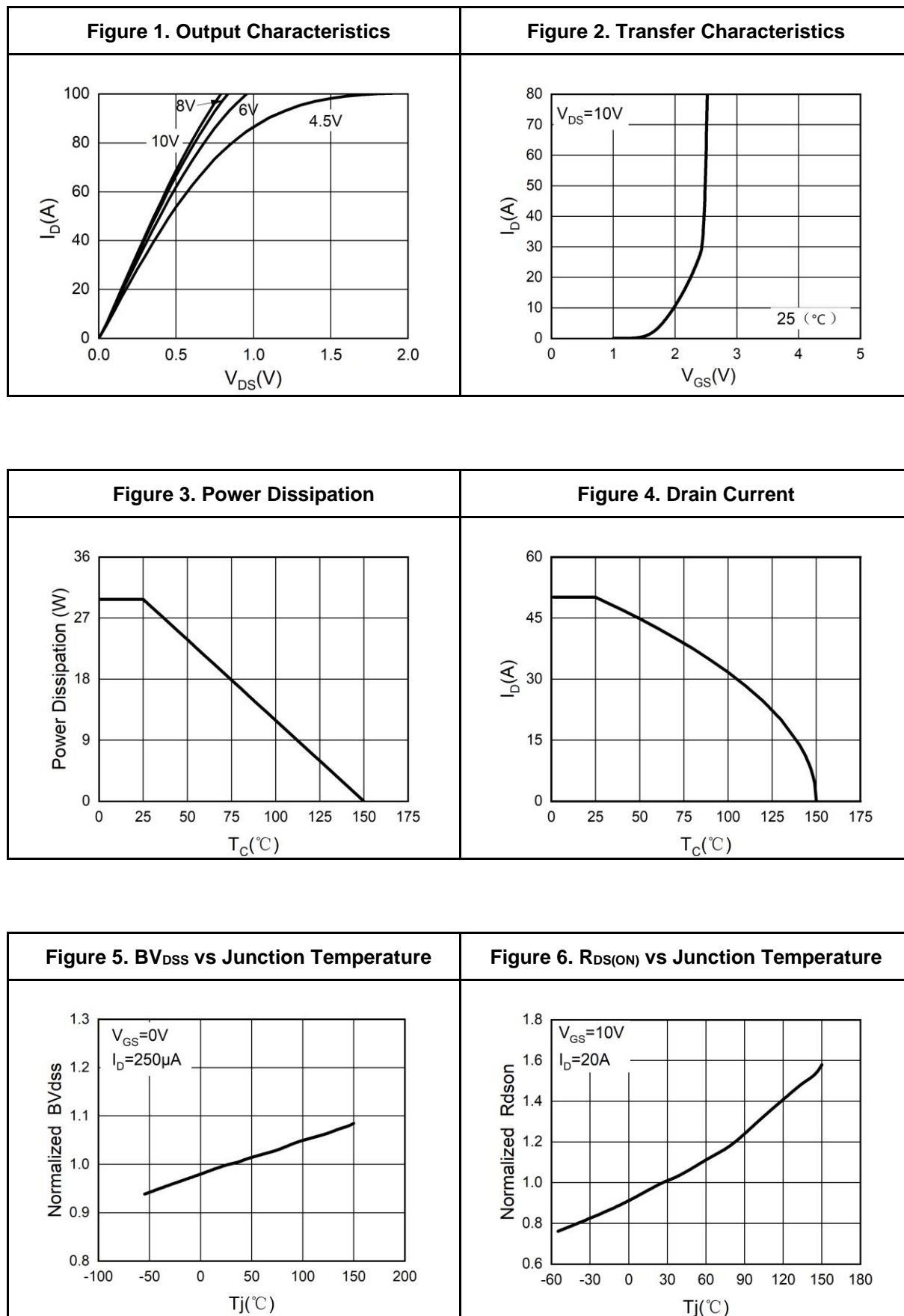



## 30V N-Channel Trench Power MOSFET

### Typical Electrical And Thermal Characteristics (Curves)

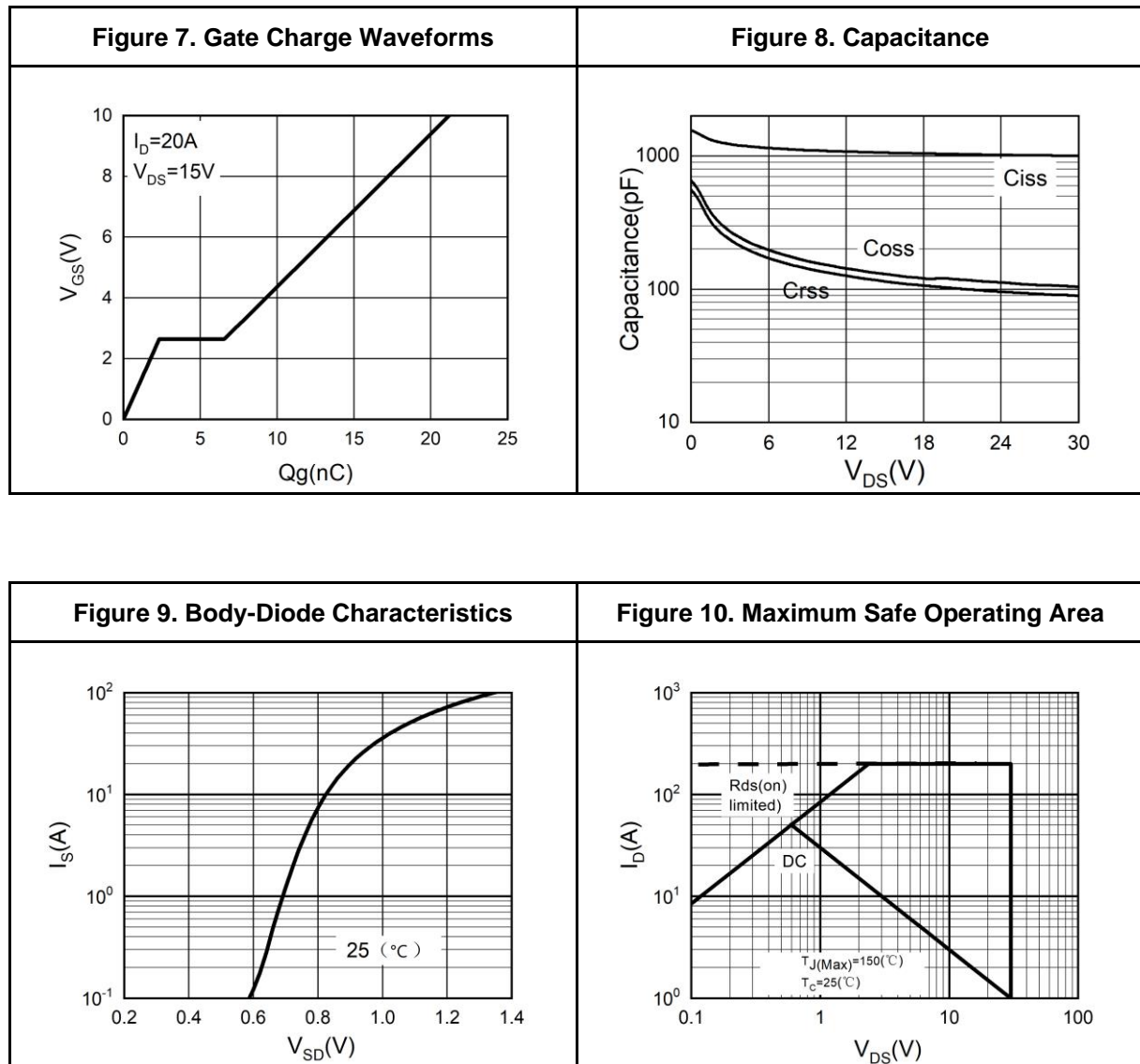



PDFN3X3-8L Package Information

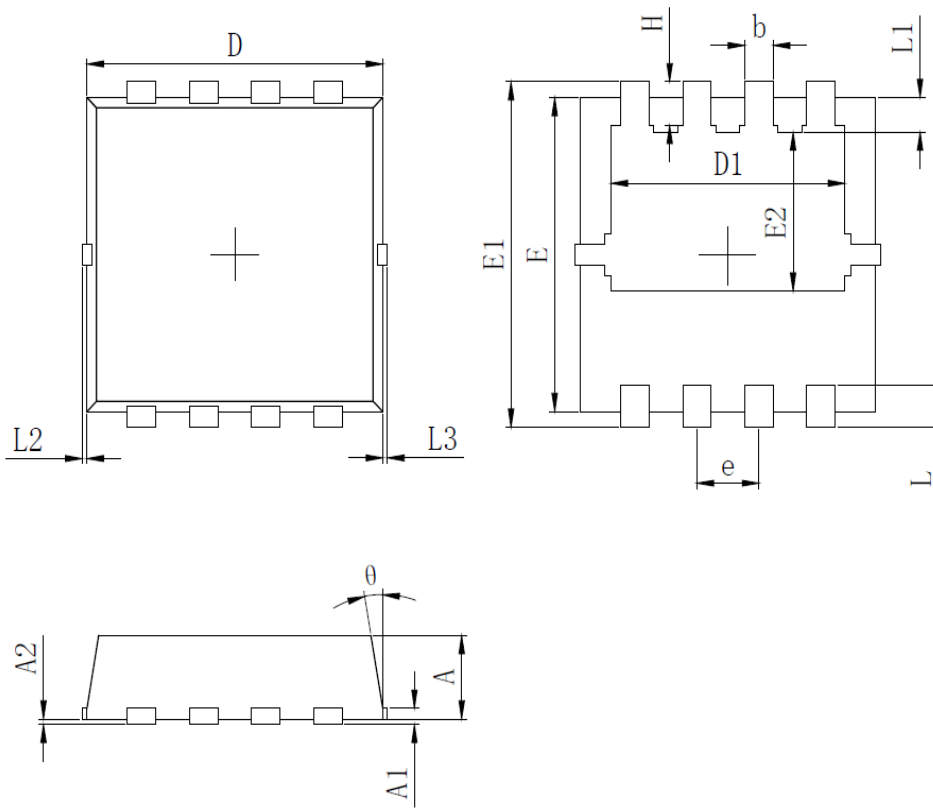

SYMBOL	MILLIMETER		
	MIN	Typ.	MAX
A	0.700	0.800	0.900
A1	0.152 REF.		
A2	0~0.05		
D	3.000	3.100	3.200
D1	2.300	2.450	2.600
E	2.900	3.000	3.100
E1	3.150	3.300	3.450
E2	1.320	1.520	1.720
b	0.200	0.300	0.400
e	0.550	0.650	0.750
L	0.300	0.400	0.500
L1	0.180	0.330	0.480
L2	0~0.100		
L3	0~0.100		
H	0.315	0.415	0.515
θ	8°	10°	12°



## 30V N-Channel Trench Power MOSFET

---

### Attention

This product described in this document can not be used in life support devices or systems, aircraft's control systems, and other applications whose failure can be reasonably expected to result in serious physical and/or material damage, apart from that when an application agreement is signed between customer and Wuxi Shangjia Semiconductor.

The performances and characteristics of this product in the independent testing state are displayed in this document. Wuxi Shangjia Semiconductor can't guarantee of the performances and characteristics of this described product that mounted in the customer's products or equipments as same as that in the independent testing state. So the customer should evaluate and test devices mounted in the customer's products or equipments.

Wuxi Shangjia Semiconductor reserves the right to improve the designs, functions and reliability of this product and modify any and all information described in this document without notice customer, apart from that when an notice agreement is signed between customer and Wuxi Shangjia Semiconductor.

The information given in this document shall in no event be regarded as a guarantee of conditions or characteristics. With respect to any examples or hints given herein, any typical values stated herein and/or any information regarding the application of the device, Wuxi Shangjia Semiconductor hereby disclaims any and all warranties and liabilities of any kind, including without limitation, warranties of non-infringement of intellectual property rights of any third party.